



Manual Prowise Touchscreen Max



*The model shown in this manual may differ from your actual screen.

This manual applies to Prowise Touchscreens with the following product numbers:

Prowise Touchscreen Max 16:9

- 65": PW.1.19065.0001
- 75": PW.1.19075.0001
- 86": PW.1.19086.0001
- 98": PW.1.19098.0001

Prowise Touchscreen Max 21:9

- 92": PW.1.19092.0001
- 105": PW.1.19105.0001



Table of Contents

1. Unboxing your Prowise Touchscreen	3
1.1. Products and accessories	3
1.2. Product Overview	5
2. Installing your Prowise Touchscreen	7
2.1. Installation guidelines	7
2.2. Installing it yourself	8
2.3. Modular Mainboard	9
2.4. Cabling	10
3. Starting the Prowise Touchscreen for the first time	11
3.1. Powering on the touchscreen	11
3.2. Completing the installation	12
3.3. Connecting to a network	13
3.4. Windows desktop	15
4. Your Prowise Touchscreen in daily use	16
4.1. The correct position	16
4.2. Operating the touchscreen	17
4.3. Pens	18
4.4. Prowise Central (for Windows)	18
4.5. Remote control	20
4.6. NFC	24
4.7. Sensors	24
4.8. Cleaning	25
5. Connecting external devices	27
5.1. HDMI	27
5.2. USB-C	28
5.3. VGA	28
5.4. AV	29
5.5. Connecting the Prowise Touchscreen to audio equipment	29
5.6. Connecting via the HDMI port (ARC)	31
5.7. Microphone and camera passthrough	31
5.8. Connecting via the HDMI port (CEC)	32
6. Important safety instructions	33
6.1. Safety	33
6.2. Repairs	34
6.3. Environment	34
6.4. Recycling and disposal	35

1. Unboxing your Prowise Touchscreen

1.1. Products and accessories

Your Prowise Touchscreen comes with a number of standard accessories and items. Let's go through them together.

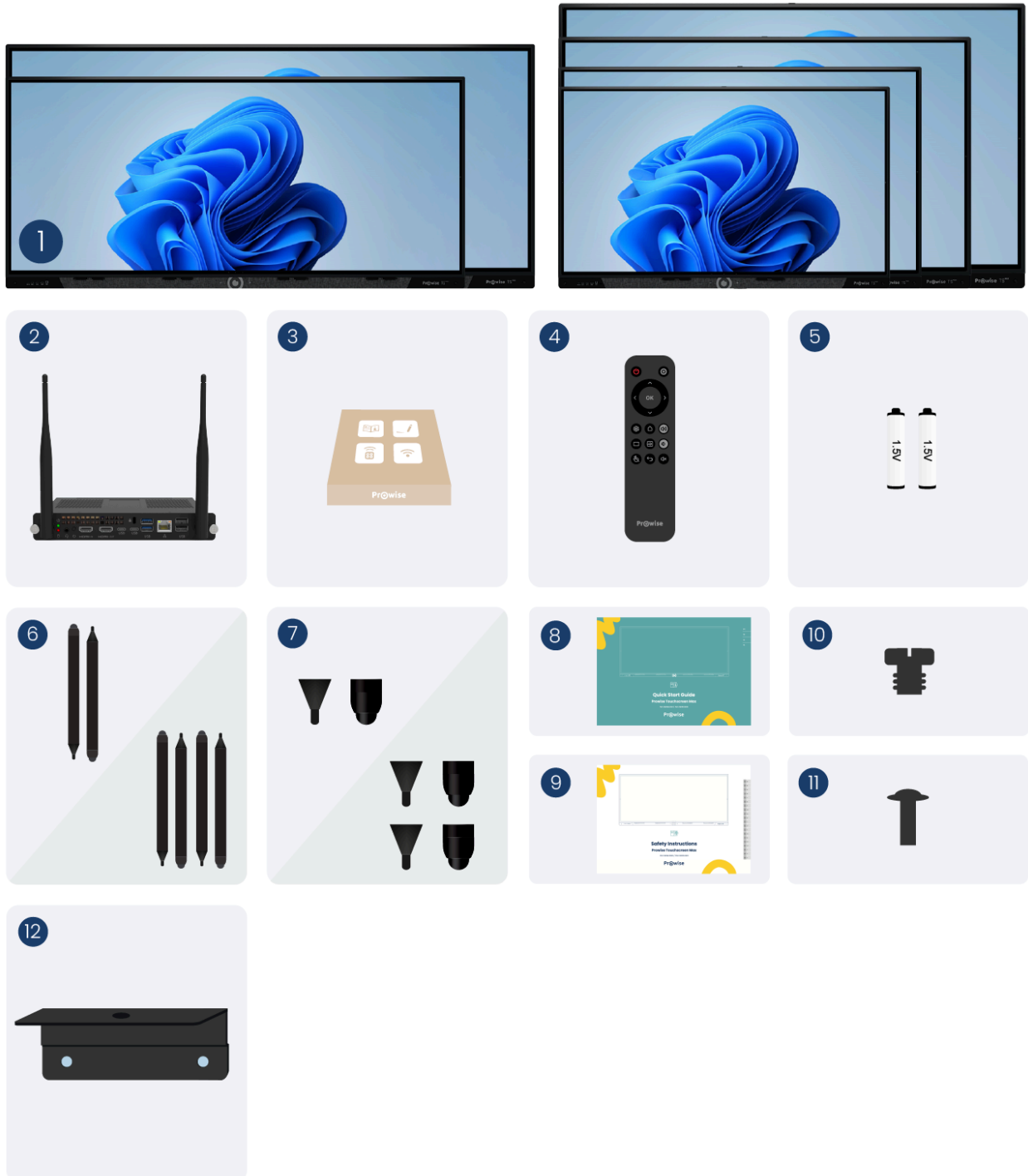

1. Prowise Touchscreen Max
2. OPS mainboard module
- 3. Accessory pack:**
4. Remote control
5. 1.5V AAA batteries (2x)
6. ProWrite® pen with various pen thicknesses (16:9 model: 2 pens or 21:9 model: 4 pens)
7. Pen tips (16:9 model: 2 sets or 21:9 model: 4 sets)
8. Quick Start Guide
9. Safety Instructions
10. 1/4 inch UNC camera screw
11. VESA screws M8 (4x)
12. Camera bracket including screw



WARNING! Keep packaging materials, such as the plastic bag, out of reach of children. Improper use of packaging materials can cause a risk of suffocation.



NOTE! Check if the delivered package is complete. If anything is missing, please contact our Service team within five (5) days after delivery. Include the serial number and a copy of the invoice.

1.2. Product Overview

Your Prowise Touchscreen is equipped with many ports and sensors. We've listed all the options for you.

Prowise Touchscreen Max

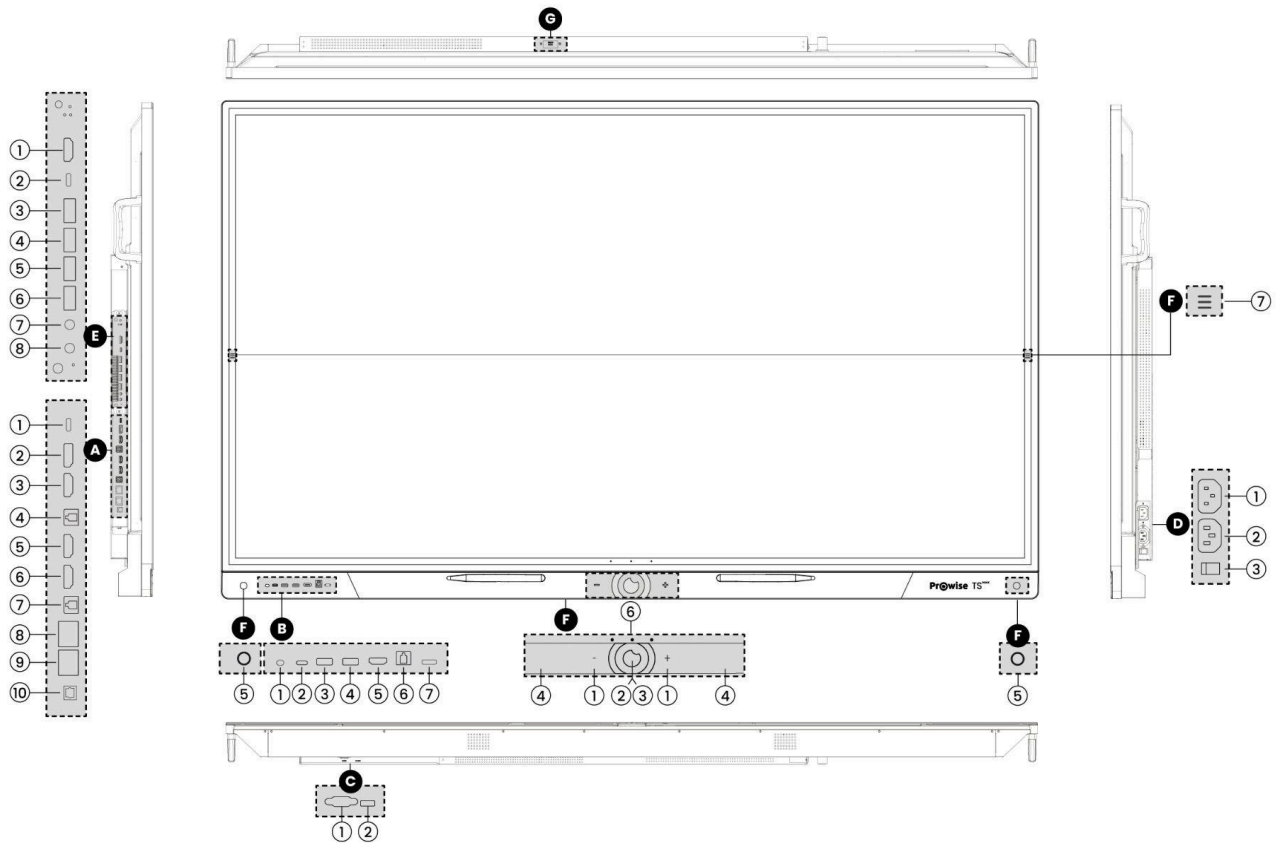

- A. Left side ports
 - 1. USB Type-C (HDMI + 100W Power + Touch + LAN)
 - 2. DP Port 1.2
 - 3. HDMI 2.1 Type A (HDCP2.3 CEC)
 - 4. USB 3.2 Gen 1 Type-B (Touch port)
 - 5. HDMI 2.1 Type A (HDCP2.3 CEC)
 - 6. HDMI 2.1 Type A (HDCP2.3 CEC)
 - 7. USB 3.2 Gen 1 Type-B (Touch port)
 - 8. LAN IN/OUT port (RJ45)
 - 9. LAN IN/OUT port (RJ45)
 - 10. S/PDIF Optical Digital Audio port
- B. Front ports
 - 1. Light sensor
 - 2. USB Type-C (Video + Audio + 15W Power + Touch)
 - 3. USB 3.2 Gen 1 Type-A
 - 4. USB 3.2 Gen 1 Type-A
 - 5. HDMI 2.0 Type A (HDCP2.2)
 - 6. USB 3.2 Gen 1 Type-B (Touch port)
 - 7. IR remote sensor
- C. Bottom ports (mainboard)
 - 1. RS232 Serial port
 - 2. USB 2.0 Type-A
- D. Right side – AC input and main switch
 - 1. AC input
 - 2. AC output
 - 3. Main switch
- E. Left side – OPS slot
 - 1. HDMI OUT
 - 2. USB Type-C OUT
 - 3. USB 3.2 Type-A
 - 4. USB 3.2 Type-A
 - 5. USB 3.2 Type-A
 - 6. USB 3.2 Type-A
 - 7. MIC IN
 - 8. Audio out – Headphones
- F. Front buttons and sensors
 - 1. Volume + / Volume –
 - 2. Home button
 - 3. NFC sensor
 - 4. Microphones
 - 5. Proximity sensors
 - 6. Customisable buttons
 - 7. Menu buttons
- G. Top ports
 - 1. USB-C for camera connection

2. Installing your Prowise Touchscreen

2.1. Installation guidelines

We recommend not installing the touchscreen yourself or having it installed by a third party. Let Prowise or a certified Prowise partner handle the installation or mounting to prevent potential damage.

- Do not install or place the touchscreen on an unstable wall or floor, and make sure the surface is strong enough to support the screen.
- Do not use the touchscreen in industrial environments where it may be exposed to frequent vibrations, moisture or dust.
- Keep the touchscreen and all connected devices away from water and avoid exposure to dust and heat.
- Do not place the touchscreen near heat-generating equipment.
- Make sure the ventilation openings at the back of the touchscreen remain uncovered, so warm air can escape – for example, do not place it in a closed cabinet.
- Connect the touchscreen only to a grounded power outlet.

The Prowise Touchscreen can be used in environments with temperatures between 0 °C and +38 °C and relative humidity between 10% and 90% (non-condensing).

When powered off, the touchscreen can be stored at temperatures between -20 °C and +60 °C and humidity between 10% and 90% (non-condensing).



WARNING! Use the touchscreen for a maximum of 16 hours per day to avoid overloading the system. Failure to follow this instruction may result in errors or damage to the touchscreen.

2.2. Installing it yourself

We don't recommend it, but if you choose to install the touchscreen yourself or have someone else do it, follow these steps:

- Never install the touchscreen alone.
- Use a certified Prowise wall mount to attach the Prowise Touchscreen to a wall.
- Use a Prowise VESA mount to install the screen on a Prowise lift system.
- Make sure the wall is strong enough to support the weight of the touchscreen.
- Connect the cables (the required cables depend on the external devices or sources you are using, such as a lift system).

A modular OPS mainboard from Prowise is required to use the screen. Without this module, the screen will not start. Make sure the module is properly inserted and locked. Install the module as described in the chapter 'Installing the modular mainboard'.

- Only plug in the power cable when all other elements have been connected. Use only the power cable certified by Prowise.



NOTE! Prowise cannot be held responsible for any damage or injury caused by incorrect installation of the touchscreen by third parties. Damage caused by improper installation by third parties is not covered by the warranty. Always contact Prowise or a certified partner if you have any questions about the installation.



WARNING! Unplug the power cable during thunderstorms. For extra safety, we recommend using a surge protector to prevent damage to the touchscreen from power surges or lightning strikes.

2.3. Modular Mainboard



WARNING! Make sure the power cable of the Prowise Touchscreen is unplugged before installing the module.

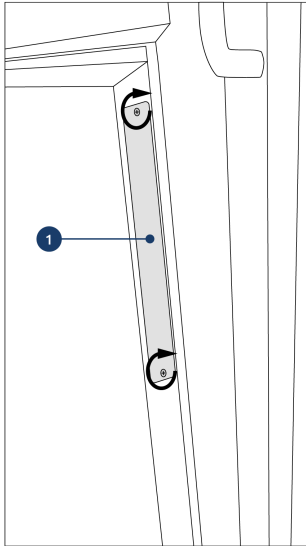

1. Loosen the screws

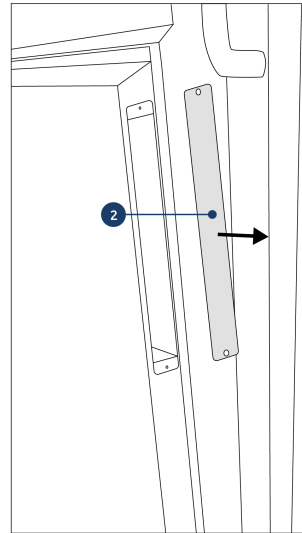

2. Remove the cover plate

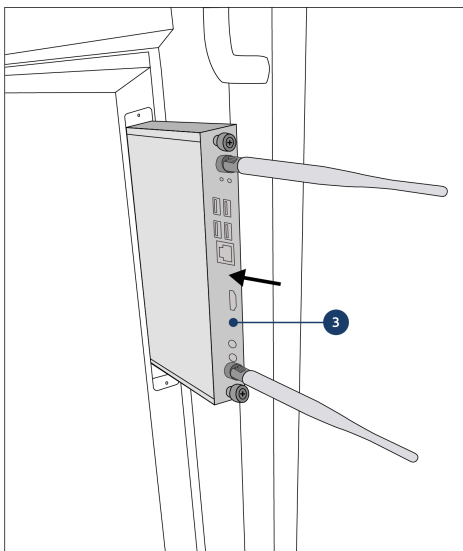

3. Insert the modular mainboard (OPS) into the slot. Make sure the ventilation holes of the PC module align with the ventilation holes in the back panel of the screen.

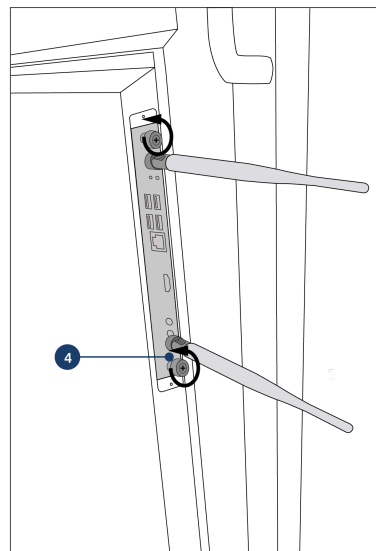

4. Tighten the securing screws of the PC module

2.4. Cabling

Only use the power cable certified by Prowise to connect the Prowise Touchscreen to a grounded power outlet. The touchscreen should be placed close to the outlet, and the socket must be easily accessible. Do not place cables across walkways to prevent tripping or stepping on them. Avoid placing objects on the cables to prevent damage.

Be careful not to overload power strips, as this may cause a short circuit. For extra safety, we recommend using a surge protector.



NOTE! Plug the power cable only into grounded outlets with AC 100–240V ~ 50/60Hz. If you are unsure about the voltage at the installation location, contact your energy provider.



NOTE! Always fully power off the touchscreen before moving it by switching off the main power button and unplugging the power cable.

3. Starting the Prowise Touchscreen for the first time

3.1. Powering on the touchscreen

Turning it on

- Make sure the touchscreen is connected to a power outlet.
- Switch on the power switch on the right-hand side of the touchscreen.

There are several ways to turn on the touchscreen after the power switch is activated:

- Press the control button in the centre of the speaker bar
- Press the power button on the supplied remote control
- Via RS232
- If the proximity sensors are enabled and detect movement

The control button is located in the middle of the speaker bar of the touchscreen.

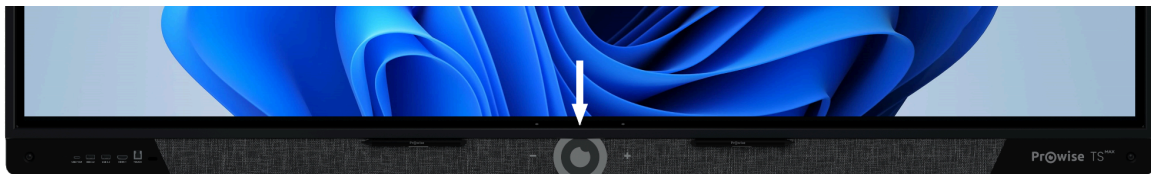

Control button

- If the touchscreen is in standby mode, press this button briefly to turn it back on.
- When the touchscreen is on, press and hold this button to power it off, use the freeze function, or the blank screen function.
- When the touchscreen is on, press this button briefly to open the Central menu.

LED indicator (bottom left corner)

- Touchscreen is on: blue
- Backlight is off: blue
- Sleep mode: flashing red (every 2 seconds)
- Standby mode: red

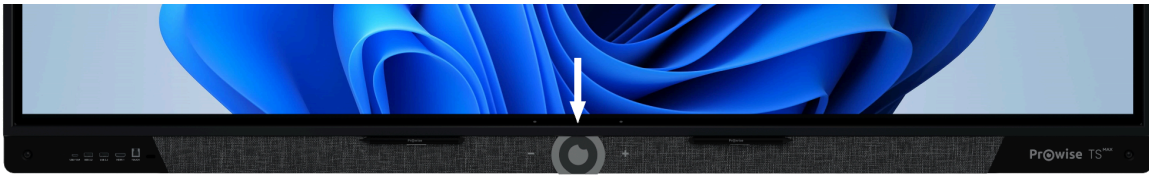

Shutting down

1. Press and hold the control button in the centre of the speaker bar or the power button on the remote control for a few seconds.
2. The message 'The system will shut down in 10 seconds' will appear.
3. Select 'Shut down' if you want to power off the touchscreen, or wait 10 seconds. To cancel the shutdown, press 'Cancel'.
4. Turn off the main power using the power switch located on the back right of the touchscreen (see image).

Automatic shutdown

If no active input source is detected on a selected input channel, a shutdown message appears after 3 minutes. If no action is taken, the touchscreen will automatically shut down after 10 seconds.

If the proximity sensors are enabled, the screen will also shut down after a certain time if no movement is detected.

3.2. Completing the installation

The first time you start your touchscreen, a Windows setup guide will open to help you configure the basic settings. Follow these steps to complete the installation:

1. Make sure the touchscreen is connected to a power outlet.
2. Turn on the power switch.
3. Press the power button (control button or remote control).
4. The touchscreen starts up and displays the setup guide.
5. Follow the steps on the screen to complete the setup.
6. You're now ready to get started with your Prowise Touchscreen.

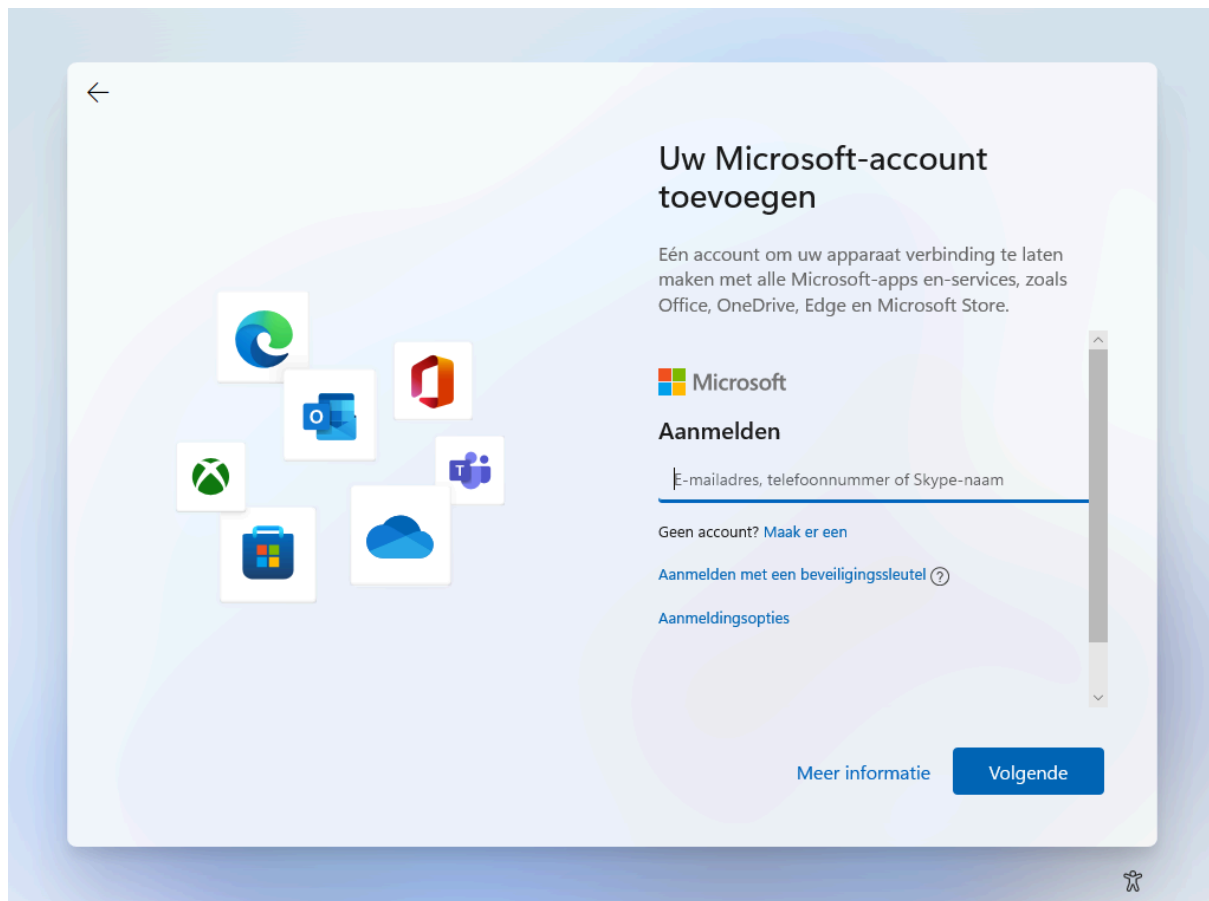

3.3. Connecting to a network

During installation, the screen needs to connect to the internet to log in with a Microsoft account. You can connect via Wi-Fi or plug in a network cable as described below under 'Ethernet'.

You can easily adjust these settings later via the Windows settings.

Tip: Visit support.windows.com for more information on Windows settings.

Ethernet

Connect the network cable to one of the LAN IN ports on your touchscreen. The touchscreen will automatically detect the network and connect to it once 'Ethernet' is enabled in the Windows settings.

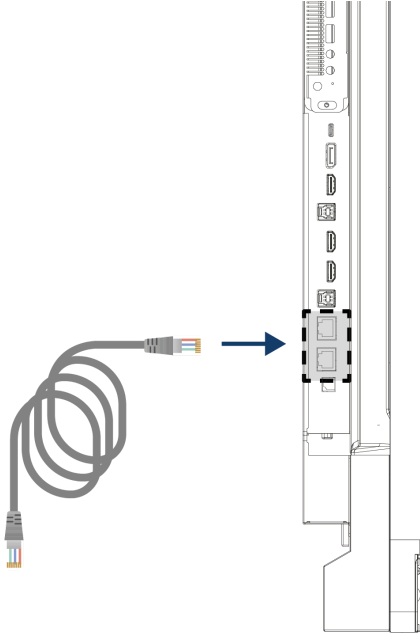

To view the network specifications, follow these steps:

1. Open the Windows desktop via the settings in the hybrid menu (see section '4.4 Windows desktop')
2. Click 'Start', then select 'Settings', or search for 'Settings' in the search bar
3. Choose 'Network & Internet'

You can easily daisy-chain the LAN connection by using the other LAN OUT port on the screen.

Note: LAN passthrough is only possible if the touchscreen itself is connected to a LAN cable and powered on.

When a device is connected via the LAN port, it will receive its own IP and MAC address.

Wi-Fi connection

Follow these steps to connect to a Wi-Fi network:

1. Check that the Wi-Fi antennas are properly installed on the OPS
2. Open the Windows desktop via the hybrid menu settings (see section '4.4 Windows desktop')
3. Tap the Wi-Fi icon in the bottom-right of the Windows taskbar
4. Tap the desired wireless network and select 'Connect'
5. Enter the network password. Tap the eye icon to reveal the password characters
6. Tap 'Connect' to connect to the wireless network

Bluetooth

1. Open the Windows desktop via the hybrid menu settings (see section '4.4 Windows desktop')
2. Open the Start menu and tap the gear icon to go to Settings
3. Click 'Bluetooth & devices'
4. Switch Bluetooth to 'On'
5. Select 'Add device' and choose Bluetooth
6. Select the desired device from the list and follow the instructions to pair

Tip: Make sure the Bluetooth device is turned on and in pairing mode.

3.4. Windows desktop

To switch to the Windows desktop:

1. Tap the hamburger icon (three horizontal lines) on one side of the screen to open the hybrid menu
2. Go to Settings → General
3. Enable or disable the 'Desktop' option to go to the Windows desktop

Tip: Swipe up from the bottom of the screen to show the Windows taskbar.

4. Your Prowise Touchscreen in daily use

4.1. The correct position

Always adjust the screen to the right working height. Avoid leaning forward and make sure both the top and bottom of the screen are within arm's reach. The screen is in the optimal position when you can touch both the top and bottom without bending down or reaching up. Placing the screen at the correct height helps prevent physical strain caused by poor posture.

Prowise recommends using the touchscreen in combination with a Prowise lift system to always ensure the ideal screen height and position.



The Prowise iPro Lift Systems connect to the screen via a USB cable using the USB 2.0 port. This allows you to control the lift from the screen and set custom presets.



DANGER! Risk of injury. Do not stand on a chair, stool, or any other object to operate the touchscreen – especially children! This poses a risk of falling and serious injury. Make sure the screen is installed at the correct height or the lift is adjusted properly when the screen is in use.

4.2. Operating the touchscreen

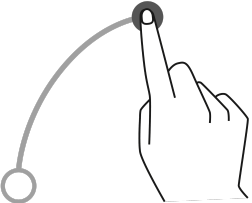
Prowise Touchscreens support up to 50 touch points, allowing multiple people to use the screen at the same time.

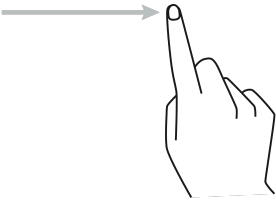
	Clicking	Tap the touchscreen with one finger to click on a specific part of the screen.
	Dragging	Tap and hold an item with one finger, then move it to a new location without lifting your finger from the screen.
	Right-click	Tap and hold one finger on the screen for a few seconds.
	Scrolling	Swipe one finger across the screen in the desired direction.

The touchscreen can also be operated using a (connected) computer mouse, the included remote control, or the optional Prowise Magic Remote.

4.3. Pens

The Prowise Touchscreen comes with four dual-tip pens (21:9 model) or two dual-tip pens (16:9 model). This allows you to write in two different colours simultaneously and erase with your palm, for example in Prowise Teach.

The screen is also equipped with pick-up recognition. When a pen is picked up, the annotation mode can open automatically.

This feature can be customised in the Prowise hybrid menu.

4.4. Prowise Central (for Windows)

When the screen starts up, the Prowise Central screen appears automatically. From here, you can easily access useful apps and settings.

Use the hybrid menu to switch between Prowise Central and the Windows desktop.

Hybrid menu

On the left and right sidebars of the Prowise Touchscreen Max, you'll see hamburger icons (three horizontal lines). Tap one to activate the hybrid menu. This gives you quick access to various functions.

You can also open the hybrid menu by placing five fingers on the screen and holding them there for at least two seconds.



Tip: Use the Prowise icon to move the hybrid menu to any position on the screen.

If you drag the menu to one of the sides, it will change into a sidebar.

OTA updates

OTA (over-the-air) updates ensure your touchscreen is always running the latest software version. All you need is an internet connection to Prowise Central—via Wi-Fi or Ethernet.





When an update is available, a pop-up message will appear in the bottom-right corner of the screen. If it's not a good time to update, you can simply dismiss the message. Updates can always be accessed later through the settings in the hybrid menu.



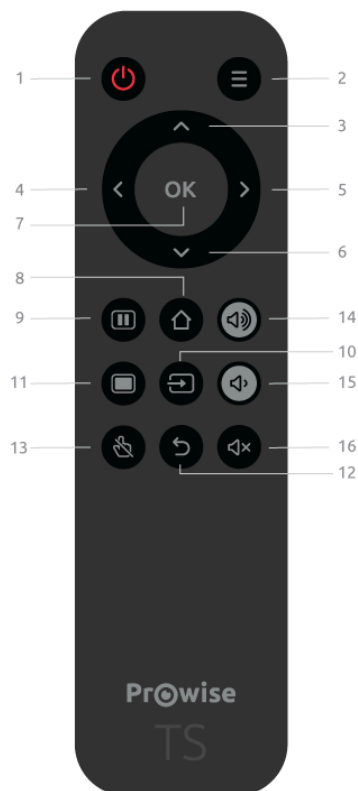





To check for available software updates:

- Open the hybrid menu
- Go to 'Settings'
- Tap 'About'
- Check the current version
- Tap 'Update' to start the update
- The screen will turn off to complete the update and can be turned back on once the process is finished.

4.5. Remote control

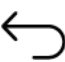

1		Press this button to turn the touchscreen on or off. Then press the Enter button to confirm the shutdown command.
2		Context button – Right-click
3		Navigation button – Up
4		Navigation button – Left
5		Navigation button – Right
6		Navigation button – Down
7	OK	Confirm selection

8		If an input other than the Prowise Central homepage is active, this button can be used to return to the Prowise Central homepage.
9		Freeze the screen display.
10		Open the input source selection from the hybrid menu.
11		Temporarily turn off the display. A black screen will appear, while programs continue running in the background.
12		Go one step back.
13		Enable or disable the touch function.
14		Increase the volume level.
15		Decrease the volume level.
16		Turn the internal speakers of the touchscreen on or off.

Point the remote control at the infrared receiver of the touchscreen (bottom-left corner of the screen). The remote control has a range of approximately eight metres.

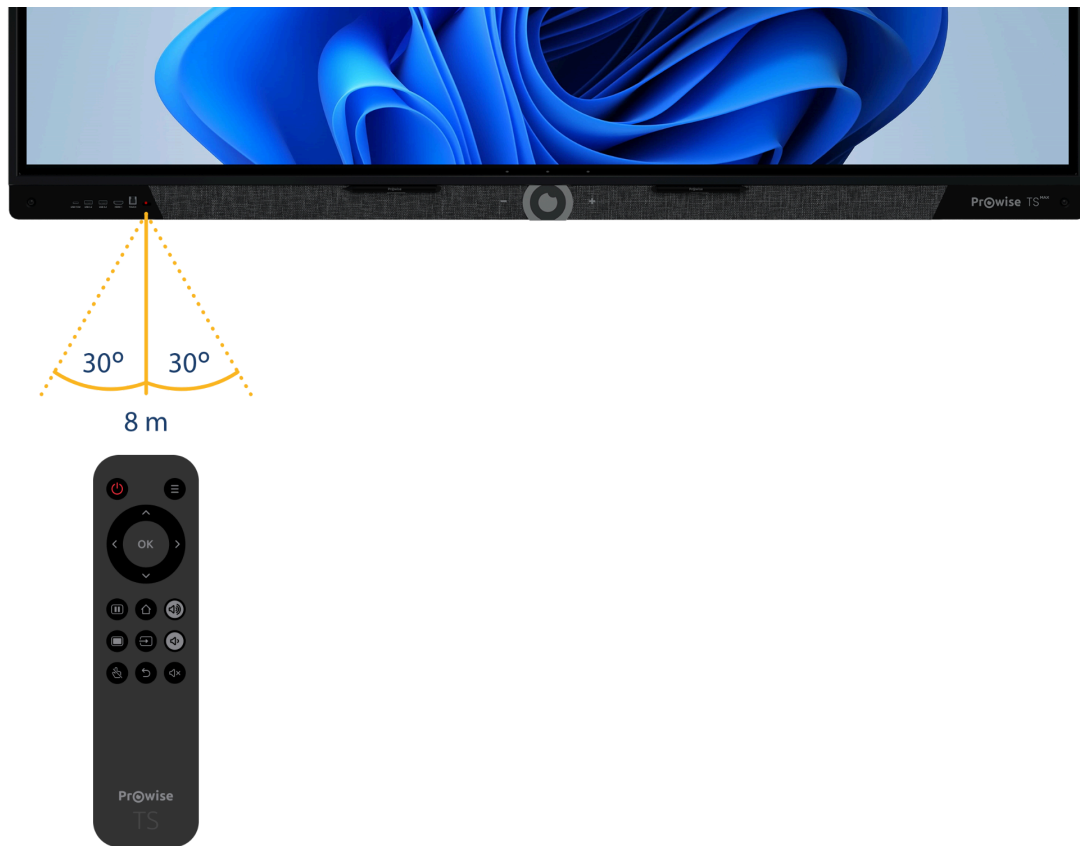

NOTE! If there are obstacles between the remote control and the receiver, the remote may not function correctly.

Replacing the remote control batteries

Before using the remote control for the first time, insert the two supplied 1.5V AAA batteries.

When the batteries are nearly empty and the remote control no longer functions properly, replace them as follows:

1. Carefully remove the cover on the back of the remote control.
2. Insert two 1.5V AAA batteries.
3. Make sure to match the positive and negative ends as indicated by the (+) and (–) symbols in the battery compartment.
4. Gently close the battery compartment by placing the cover back.

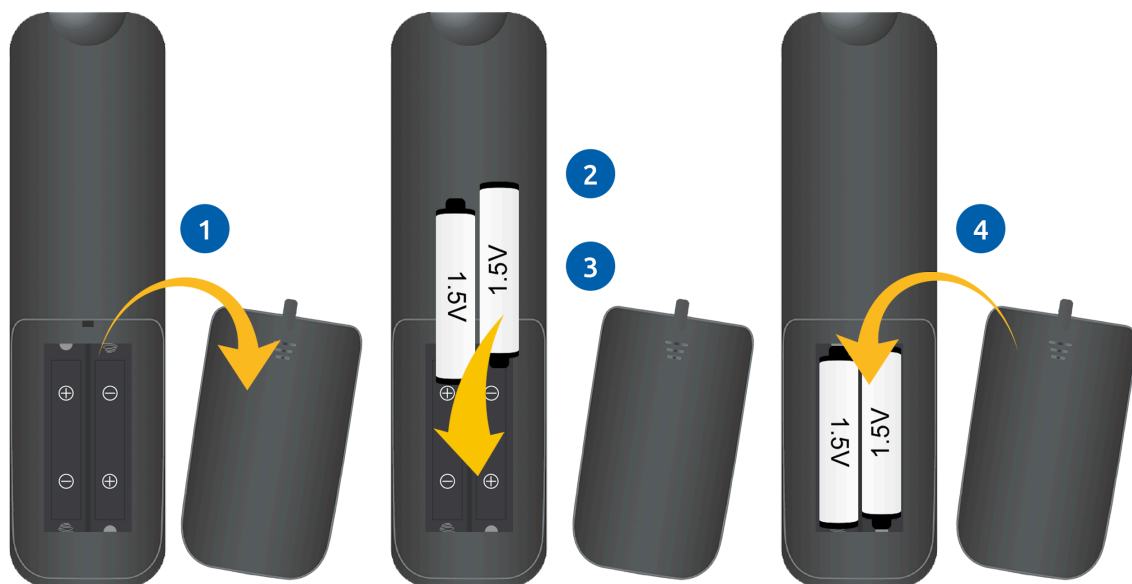

WARNING! Remove any leaking batteries from the remote control as soon as possible. Wash your hands thoroughly afterward. Leaking chemicals are toxic and must never come into contact with your mouth, skin, or eyes.



NOTE! Only use 1.5V AAA batteries. Insert them as shown in the instructions on the remote control.

4.6. NFC



The NFC sensor is located directly behind the power button in the centre of the screen.

Hold the NFC card in front of the control button to log in using NFC technology.

NFC cards are an optional accessory.



NOTE! To log in using an NFC card, the card must first be configured via the Prowise Central settings menu.

4.7. Sensors

Several sensors are integrated into the bottom-left corner of the screen.

IR sensor

This is where the infrared sensor for the remote control is located. Point the remote towards this corner to ensure the signal is received properly.

Light sensor

The light sensor that adjusts the screen's brightness (if enabled) is also located here. Based on the ambient light level, the screen brightness will automatically adjust.

Motion sensors

Two motion sensors are located in the bottom-left and bottom-right corners of the screen. These environmental sensors help reduce power consumption and lower environmental impact by ensuring the screen doesn't stay on unnecessarily. The auto shut-off function is triggered when no motion is detected for a preset number of minutes. If motion is detected in the room, the screen will automatically power on. This improves the user experience. Note: It may take a few seconds for the screen to start up from standby. The motion sensors detect presence within a 3-metre range of the screen and can trigger the auto on/off function. IT administrators can configure this setting in the distribution menu.

4.8. Cleaning

Clean the screen using a dry, lint-free microfiber cloth. Make sure the cloth is clean.

If you want to use a cleaning product, always use one recommended by Prowise, such as the Prowise Screen Cleaning Kit. Do not use harsh cleaning agents, as these can damage the screen. Ensure the cleaning product has an alkaline pH value between 7 and 9. Never use a product with a pH value above 9 or below 7, as it may damage the glass panel or screen.

Never spray cleaning liquid directly onto the screen.

Always spray it onto the cloth first. The cloth should be slightly damp, not wet, to avoid screen damage.

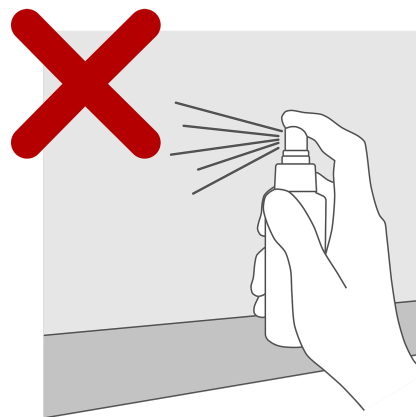
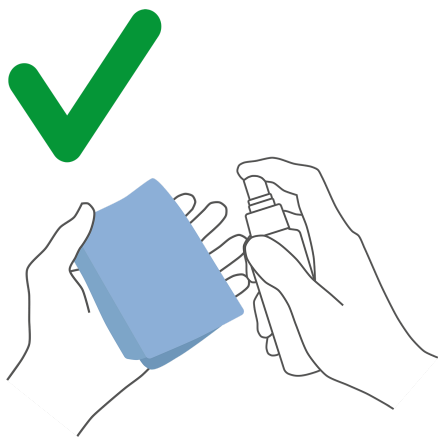

Gently wipe the screen with a cloth. For best results, clean the screen using soft, circular motions without applying pressure. Never use abrasive materials.



WARNING! If the touchscreen becomes wet, do not turn it on or plug in the power cable. This may cause an electric shock. If the touchscreen gets wet while it is turned on, immediately turn off the power and unplug the device to avoid a short circuit.



NOTE! Always unplug the power cable before cleaning the screen.

5. Connecting external devices

5.1. HDMI

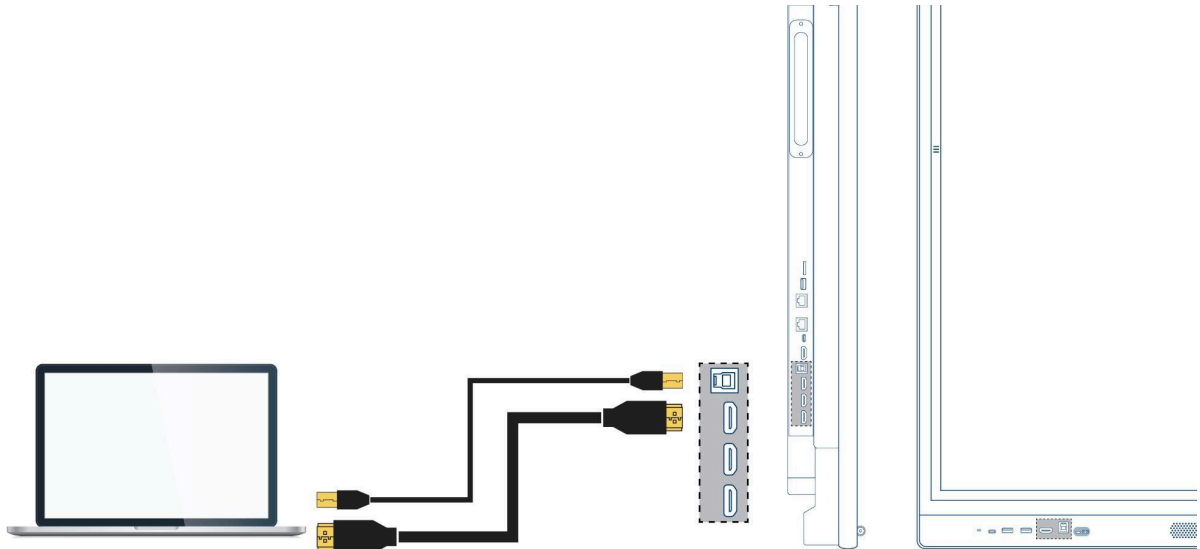

To ensure that your device, such as a laptop or desktop PC, can also be operated via touch on the touchscreen, you need to connect both a video/audio cable (HDMI) and a USB touch cable (USB-B to USB-A). This allows you to control your device directly from the touchscreen—perfect for teaching without walking back and forth to your computer. The USB touch port is located next to the HDMI ports. Make sure you use the correct USB touch port when connecting your device.

1. Connect an HDMI cable to the HDMI port of the external PC and to the HDMI input on the touchscreen.
2. Connect the USB touch cable to the USB touch port on the touchscreen and to a USB port on the external PC.
3. Once all cables are connected, turn on both the touchscreen and the external PC.
4. After both devices have started, go to the 'Input' section in the Prowise Central menu and select the correct HDMI source.



NOTE! We recommend using a high-quality cable with a length of less than 5 metres for the best connection quality.

5.2. USB-C

The full-functioning USB-C ports on the screen support multiple features. Through these ports, you can simultaneously transfer video, audio, touch, data, internet, and power—up to 100W (rear port), which is enough to power your laptop. The USB-C port on the front of the screen supports 15W power delivery. Connect your device with a USB-C cable to get started instantly with just one cable.

The USB-C port supports the following protocols:

- USB 3.0
- Video (DP 1.2, 3840×2160 @ 60Hz)
- Audio
- Touch (USB 3.0)
- Power (20V/5A/up to 100W) (rear port only)
- LAN 100 Mb/s (rear port only)



NOTE! Make sure the USB-C cable is of high quality and not too long to ensure a stable connection.



NOTE! Data transfer via the USB-C port only works in Prowise Central. This is because the port does not pass through to other input sources. (The USB-C port supports storage devices up to 16TB.)

5.3 VGA

You can also connect an external device to the Prowise Touchscreen using a VGA cable.

Note: VGA only carries video. Audio must be connected separately via a 3.5mm stereo jack to the PC audio in port, and touch functionality requires a USB touch cable.

1. Connect a VGA cable to the VGA port of the external PC and to the VGA input on the touchscreen.
2. Then connect a 3.5mm stereo jack to the PC audio in port.
3. To enable touch functionality, also connect a USB touch cable (USB-B to USB-A).
4. Once all cables are connected, turn on the touchscreen and the external device.
5. After both have started, go to the 'Input' section in the Prowise Central menu and select the VGA source.

5.4. AV

The composite video signal (CVBS) combines video and audio into a single signal.

You can connect a composite video source to the Prowise Touchscreen via the AV IN port using a 3.5mm jack plug (male, with 3 rings: audio L, audio R, and video).

5.5. Connecting the Prowise Touchscreen to audio equipment

5.5.1. Connecting headphones

To connect headphones, plug them into the analog audio output labeled 'Headphone'.

Use the touchscreen's volume control to adjust the headphone volume.

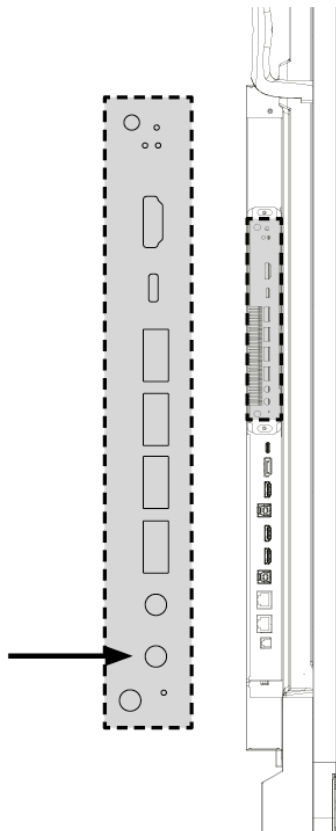

5.5.2. Connecting an amplifier

Connect an amplifier to the touchscreen using either the analog audio output or the digital optical SPDIF port. Use the amplifier's volume control to adjust the volume.

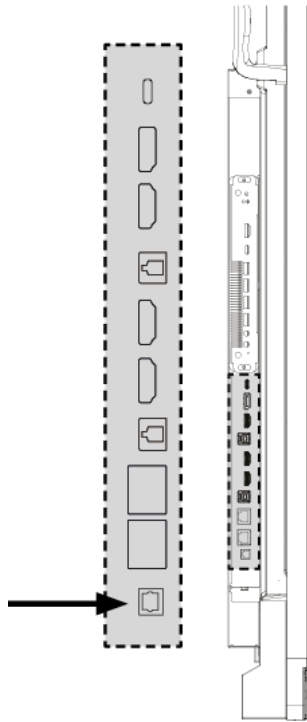

NOTE! The audio outputs (both the analog line-out and digital SPDIF port) are always active. If you connect an external audio device and only want to use that device, press the 'Mute' button on the remote control or in the menu to turn off the touchscreen's internal speakers.

5.5.3. Connecting a microphone

Connect a microphone using the microphone port located on the left side of the screen, on the mainboard module.

The microphone will function as an amplifier through the touchscreen's built-in speakers.

Make sure there is enough distance between the screen and the microphone to avoid a feedback loop.

5.6. Connecting via the HDMI port (ARC)

You can connect an external audio device using an ARC (Audio Return Channel) connection. This allows you to control the external audio device through the touchscreen.

To connect an audio device via ARC:

- Plug one end of an HDMI cable into the ARC-supported HDMI port on the touchscreen
- Plug the other end into the HDMI port of the external audio device.

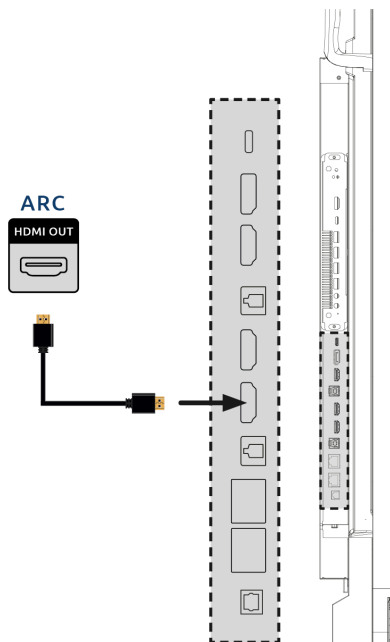

5.7. Microphone and camera passthrough

Microphone and camera passthrough allows your microphone and camera input on the touchscreen to be redirected to your personal device.

This makes it easy to join video calls via Skype, Teams, Zoom, Google Meet, and more.

Technical

- Your personal device must be connected to the USB touch port or USB-C port on the screen.
- Make sure the USB cable is not too long — we recommend a length between 3 and 5 metres.

5.8. Connecting via the HDMI port (CEC)

CEC (Consumer Electronics Control) is a feature that operates via HDMI. Devices connected in this way can communicate with each other through CEC, allowing them to be controlled using the touchscreen's remote control.

To connect a device via CEC, insert an HDMI cable into the HDMI port of the touchscreen.

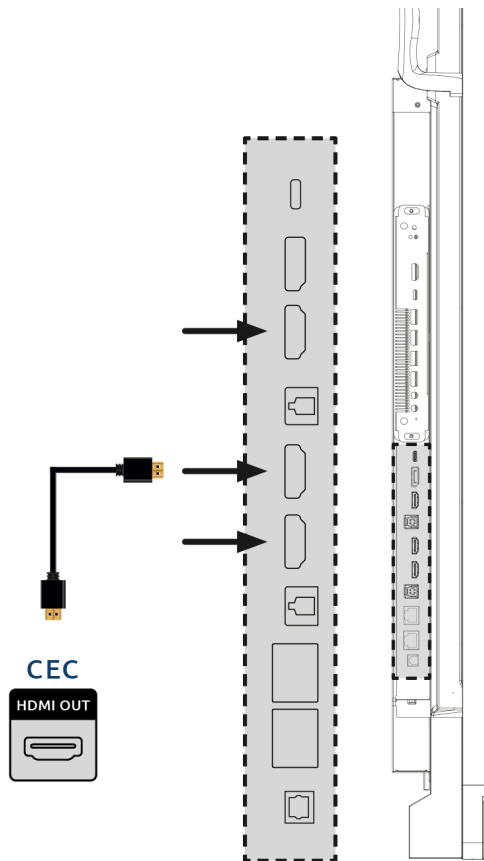

6. Important safety instructions



WARNING! Read this user manual and the separate safety instructions carefully before using the Prowise touchscreen.
Follow all warnings on the device, in the user manual, and in the safety instructions.
Always keep the safety instructions and the user manual within easy reach.

If the device is used for purposes other than those described in the safety instructions and this manual, Prowise B.V. accepts no liability for material damage and/or injury.

Do not make any modifications to the device without written permission from Prowise.

Improper use will void the warranty.

6.1. Safety

- Never open the casing of the touchscreen! This may cause electric shock or short circuit.
- Do not use the touchscreen during a thunderstorm. Unplug the device to avoid lightning damage.
- Make sure your touchscreen does not get wet! This can cause short circuits and a risk of electrocution.
- Do not install the device near water, and do not place objects containing liquid on or next to it.
- High volume can cause permanent hearing damage. Prolonged use at high volume levels may result in hearing loss.
- Only use components and accessories supplied by Prowise.
- Always switch off the touchscreen and unplug it before replacing a module.
- Do not insert any objects into the openings of the touchscreen unless specifically intended for that purpose.
- Doing so may result in short circuit or even fire.

6.2. Repairs

Repareer het touchscreen nooit zelf! Indien reparaties door derden of onbevoegden worden uitgevoerd zal de garantie vervallen.



WARNING! Warning for electrical components!
Never open the casing of the touchscreen! This may result in electric shock, short circuit, or even fire. This could cause injury or damage to yourself and/or the device.

Always contact Prowise or a certified partner in case of a defect to avoid further damage.

For contact information, visit: www.prowise.com

6.3. Environment

- Unplug the power cable if the screen will not be used for an extended period.
- Power consumption in standby mode is less than 0.5 watts.
- The Prowise Touchscreen is ENERGY STAR certified.
- When the screen is no longer usable, dispose of it at a designated recycling point.



NOTE! If WOL (Wake on LAN) and WOS (Wake on Source) are enabled, standby power consumption will increase!

6.4. Recycling and disposal

If you have questions about proper disposal of your touchscreen, contact Prowise or an authorized partner.



Packaging

The device is packaged to prevent transport damage. The packaging is made from materials that can be reused or recycled.



Device

Do not dispose of the device with household waste at the end of its life. Ask about environmentally friendly and responsible disposal options. Prowise complies with the Dutch Extended Producer Responsibility law in cooperation with Stichting OPEN.



Batteries

Empty or damaged batteries must not be disposed of with household waste. Take them to a designated battery collection point. The remote control uses 1.5V AAA batteries.