

EN

DE

NL

FR

IT

ES

PT

NO

DA

SV

FI

CY

PL

CS

SK

RO

HU

LT

LV

ET

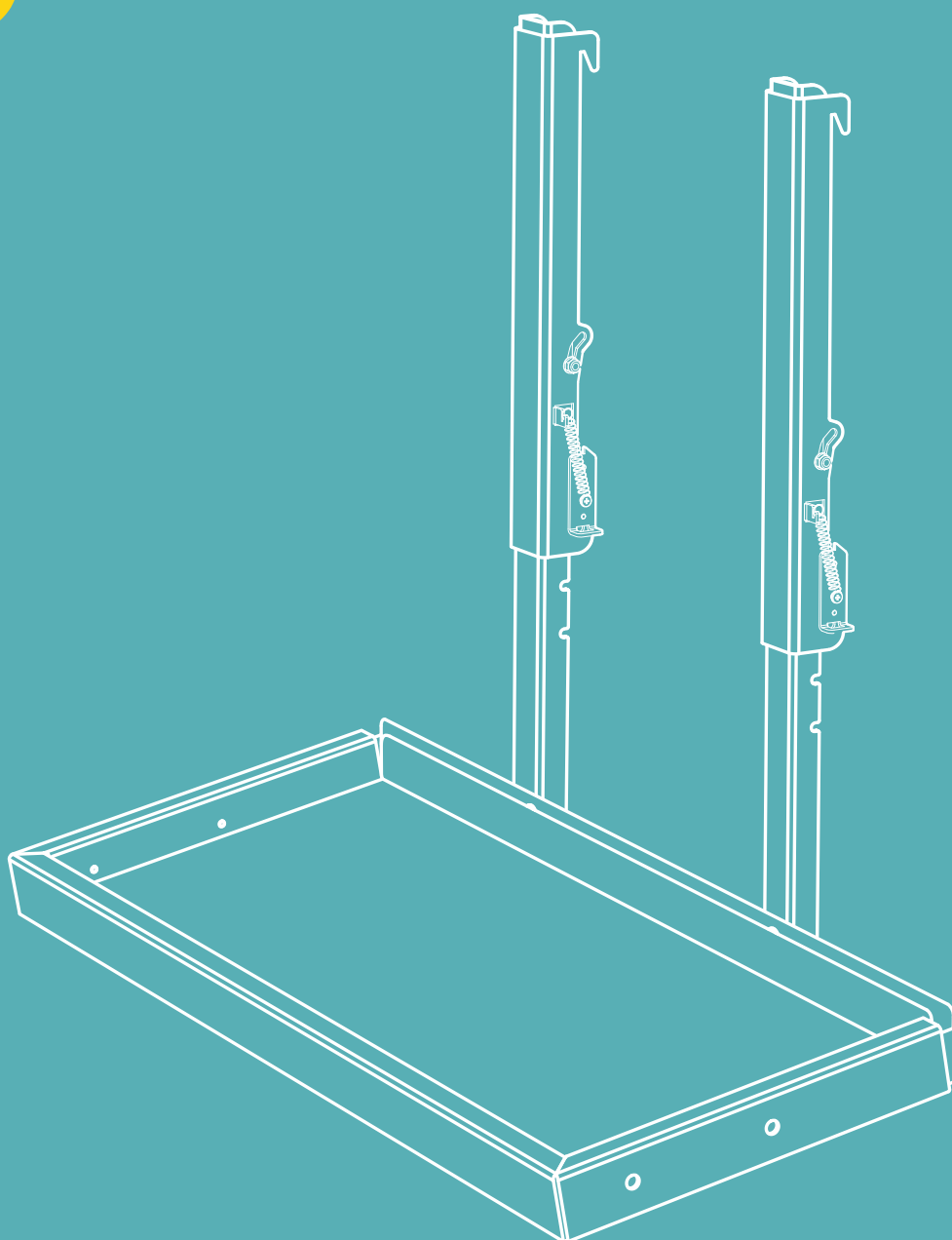

User Manual

Prowise Neo Keyboard Tray

PW.1.21001.0008

Prowise

Where can I go if I have questions?

In case you have any additional questions about the installation or use of the Keyboard Tray, our colleagues at the Customer Service department are happy to help.

✉ Please send an email to: service@prowise.com

☎ Call to: +31 (0)800 5021

📞 Send a WhatsApp to: +31 612 291 893

Safety requirements

Please read the supplied Safety Guide carefully before installing and using the Wall Mount. Please follow warnings and instructions closely and always keep the Safety Guide and User Manual at hand.



What's in the box?

1 2x Height adjustment bracket accessories

2 2x Keyboard Tray support

3 Keyboard Tray

4 2x M6x16 Button head with flange screw

5 2x Adapter bracket vesa to accessories

6 User manual

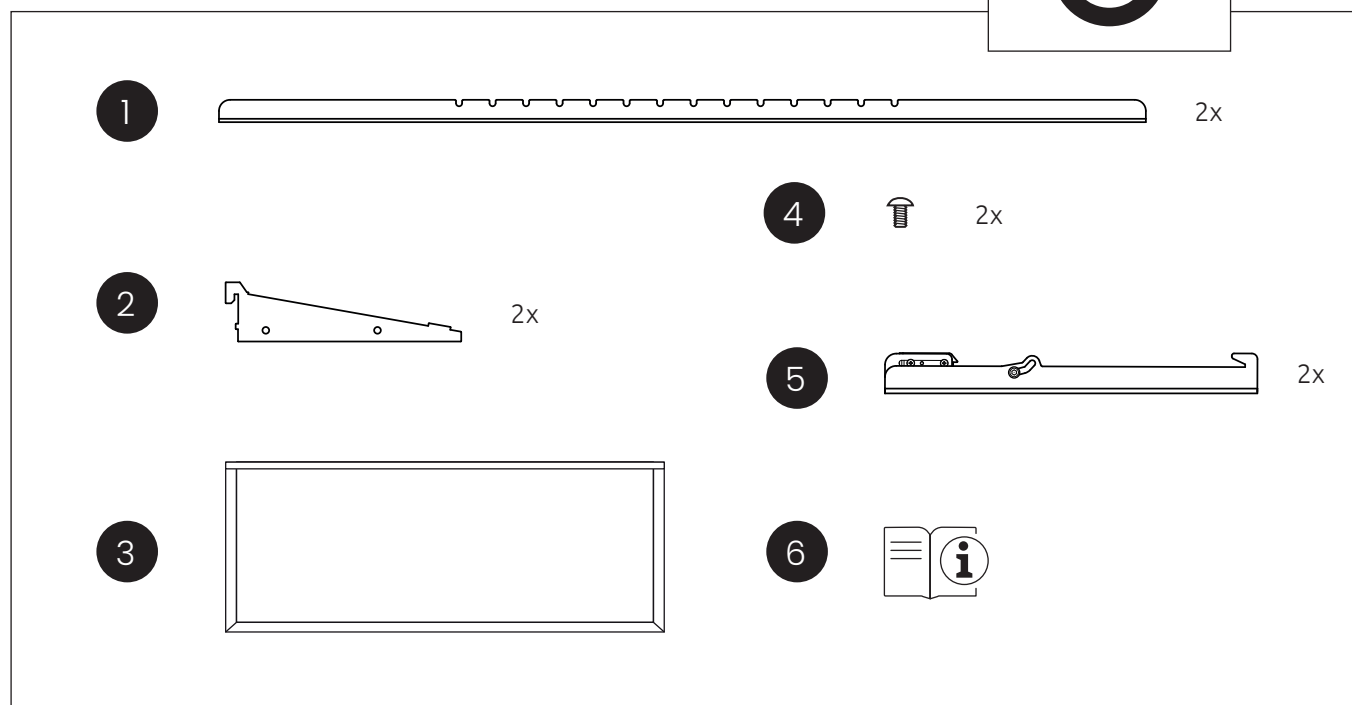
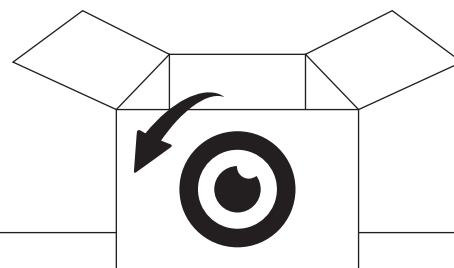

Tools you need

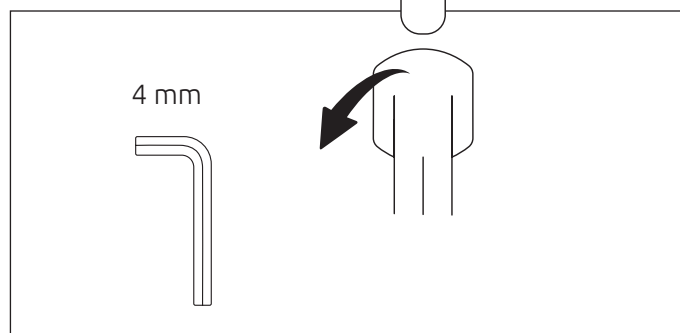

Technical installation of the Keyboard Tray

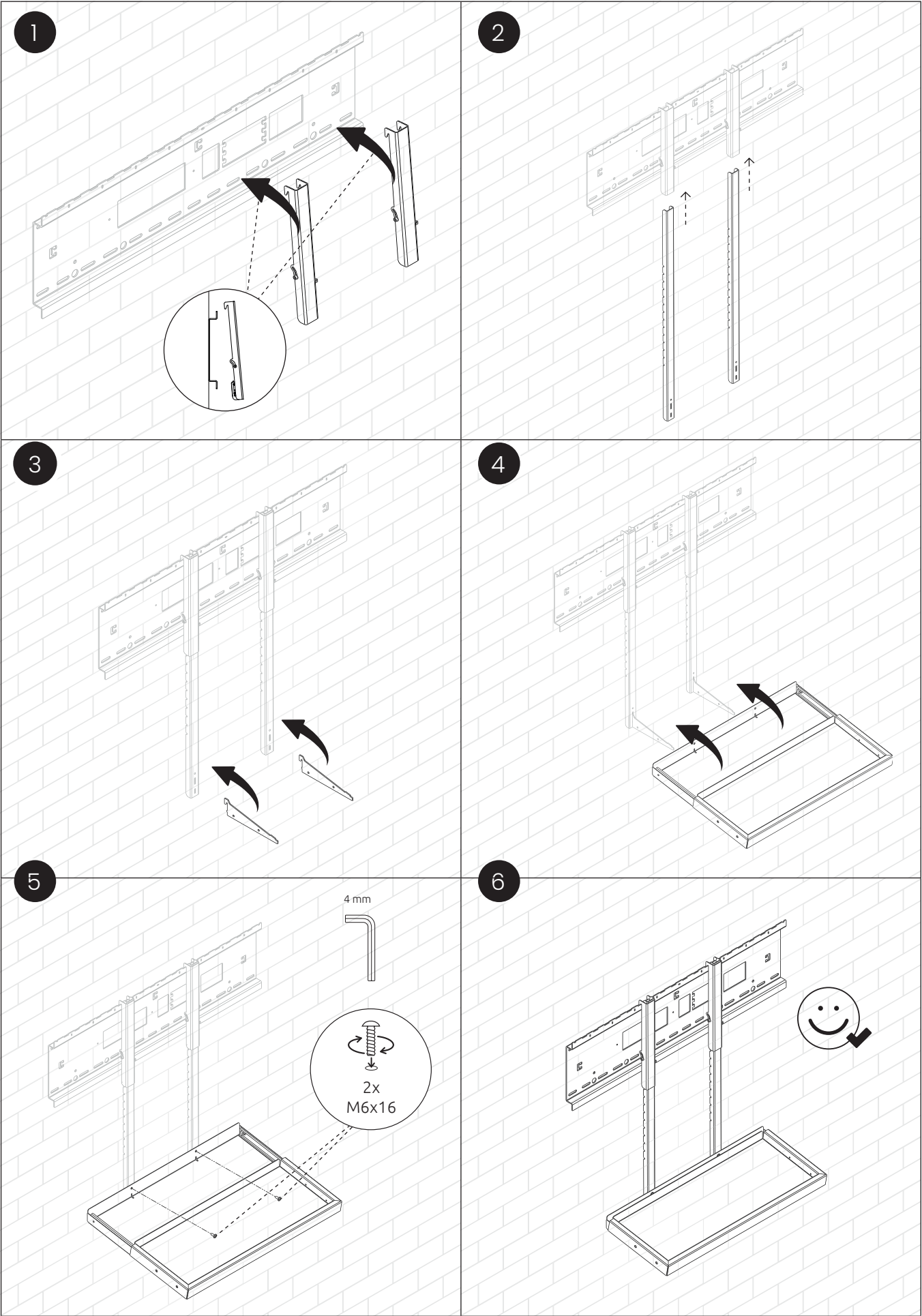

Adjusting the keyboard tray

